



16-Port Gigabit + 2-Port Gigabit SFP L2 Managed PoE Switch

FR-S3018PEGMF-E

Description

FR-S3018PEGMF-E is a new generation designed for high security and high performance network the second layer switch. Provides sixteen 10/100/1000Mbps self-adaption RJ45 port, and two 100/1000Mbps SFP optical ports, all ports support wire-speed forwarding, can provide you with larger network flexibility. Support VLAN ACL based on port, easily implement network monitoring, traffic regulation, priority tag and traffic control. Support traditional STP/RSTP/MSTP 2 link protection technology; greatly improve the ability of fault tolerance, redundancy backup to ensure the stable operation of the network. Support ACL control based on the time, easy control the access time accurately. Support 802.1x authentication based on the port and MAC, easily set user access. Perfect QOS strategy and plenty of VLAN function, easy to maintenance and management, meet the networking and access requirements of small and medium-sized enterprises, intelligent village, hotel, office network and campus network.

FR-S3018PEGMF-E 16 ports support PoE power supply function, support IEEE802.3at standard, 802.3af downward compatibility, power supply equipment for Ethernet, can automatically detect identification standard of electrical equipment, and through the cable for the power supply.

The application of topology

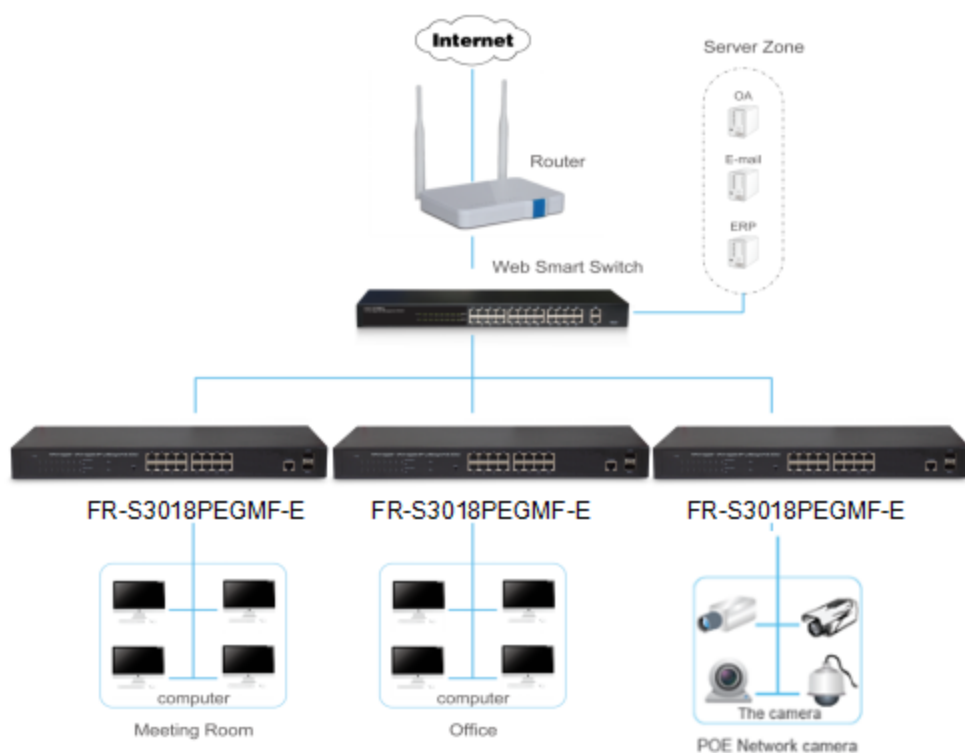

Characteristics

- 2*1000Mbps SFP ports
- Internal 260W power supply, high performance, durable stability
- Switching Capacity 36G
- Adopt the store - forwarding mode
- Support PoE management
- Complied with IEEE802.3at backward compatibility IEEE802.3af
- Supports PoE power up to 30W for each PoE port, total power up to 240W for all PoE ports

● 16-Port Gigabit + 2-Port Gigabit SFP L2 Managed PoE Switch
FR-S3018PEGMF-E

Features

- Comply with IEEE 802.3i, IEEE 802.3u, IEEE802.3x , IEEE802.3ab , IEEE802.1q , IEEE802.1p standards
- Supports IEEE802.3af、IEEE802.3at standards
- Supports PoE power up to 30W for each PoE port, total power up to 240W for all PoE ports
- Supports manage the PoE port, support PoE port power on/off and port output power restriction
- Support Web interface management
- 16 x 10/100/1000Mbps Auto MDI/MDI-X Ethernet port,Support ports Auto MDI/MDIX
- 8K entry MAC address table of the switch with auto-learning and auto-aging
- Supports IEEE802.3x flow control for Full-Euplex Mode and backpressure for Half-Euplex Mode
- supports QoS (quality of service), port mirror, Link aggregation protocol
- Support packet length 9216Bytes jumbo frame packet forwarding at wire speed
- Internal 260W power supply ,high performance, durable stability

Hardware Specification

Model Name		FR-S3018PEGMF-E
Chipset		RTL8382M+RTL8218B+RTL8231+PD69200+2*PD69208
Standards and Protocols		IEEE 802.3i、IEEE 802.3u、IEEE 802.3ab、IEEE 802.3x、IEEE 802.3z、IEEE 802.3at、IEEE 802.3af、IEEE 802.1q、IEEE 802.1p
Interface		16 x 10/100/1000Mbps Auto-Negotiation ports 2 x 100/1000Mbps SFP ports 1x Console port
Network Media		10Base-T: UTP category 3, 4, 5 cable (maximum 100m) 100Base-Tx: UTP category 5, 5e cable (maximum 100m) 1000Base-T: UTP category 5e, 6 cable (maximum 100m) 1000Base-SX:62.5µm/50µm MMF(2m~550m) 1000Base-LX:62.5µm/50µm MMF(2m~550m) Or 10µm SMF (2m~5000m)
Transfer Method		Store-and-Forward
MAC Address Table		8K
Switching Capacity		36G bps
Packet Forwarding Rate		26.784Mpps
Packet Buffer		4.1Mbit
Jumbo Frame		9216Bytes
PoE Ports(RJ45)		16* PoE ports compliant with 802.3at/af
Power Pin Assignment		1/2(+),3/6(-)
PoE Budget		240W
Indicators	Per Device	Power
	Per Port	Link/Activity/Speed, PoE
Power Supply		100~240VAC,50/60HZ,260W internal power
Power Consumption		Maximum(PoE on): 286.2W (220V/50Hz)
Dimensions (W x D x H)		440*208*44mm
Environment		Operating Temperature: 0°C~45°C Storage Temperature: -40°C~70°C Operating Humidity: 10%~90% non-condensing Storage humidity: 5%~90% non-condensing

Software Specification

<p>Basic function</p> <ul style="list-style-type: none"> ● Ethernet Setup ● STP/RSTP/MSTP ● Storm-control ● Port Monitor ● Port rate-limit ● MAC filtering 	<p>Three layers of functional</p> <ul style="list-style-type: none"> ● The ARP deception, the network cheating ● Filtering the IP port ● Static binding IP and MAC ● Arp trust port ● Ping and Traceroute 	<p>The security policy</p> <ul style="list-style-type: none"> ● ACE capacity ● ACL ● QoS ● DAI
<p>VLAN</p> <ul style="list-style-type: none"> ● Port based VLAN ● 802.1Q VLAN 	<p>Safety features</p> <ul style="list-style-type: none"> ● Radius ● Tacacs+ ● Preventing DOS attacks ● dot1x ● The gateway ARP deception 	<p>Application protocol</p> <ul style="list-style-type: none"> ● DHCP Relay ● DHCP snooping ● DHCP Client/Server ● FTP/TFTP
<p>Management</p> <ul style="list-style-type: none"> ● HTTP WEB ● Telnet ● SSH ● Console 	<p>Other function</p> <ul style="list-style-type: none"> ● LLDP ● LACP ● IGMP Snooping ● SNMPV1,V2c,V3 ● RMON (1,2,3,9) 	<p>PoE Management</p> <ul style="list-style-type: none"> ● PoE Status ● Power supply management mode(auto/static) ● The port priority