



## FR-S3126MC-370P2

### 24FE+2-port Gigabit Combo Base-T/SFP L2 Managed PoE Switch

#### Features

- Wire speed forward, intelligent recognition
- Two gigabit combo port
- Internal 400W Power supply
- High performance, durable stability
- Adopt the store - forwarding mode
- Switching Capacity 8.8Gbps
- Complied with IEEE802.3at backward compatibility IEEE802.3af
- Supports PoE power up to 30W for each PoE port, 370W for all PoE ports
- Support Web POE power supply management

#### Description

FR-S3126MC-370P2 is a new generation designed for high security and high performance network the second layer switch. Provides twenty-four 10/100Mbps self-adaption RJ45 port, and two alternative gigabit ports --two 10/100/1000Mbps RJ45 port and two 1000Mbps SFP optical ports, all ports support wire-speed forwarding, can provide you with larger network flexibility. Support VLAN ACL based on port, easily implement network monitoring, traffic regulation, priority tag and traffic control. Support traditional STP/RSTP/MSTP 2 link protection technology; greatly improve the ability of fault tolerance, redundancy backup to ensure the stable operation of the network. Support ACL control based on the time, easy control the access time accurately. Support 802.1x authentication based on the port and MAC, easily set user access. Perfect QOS strategy and plenty of VLAN function, easy to maintenance and management, meet the networking and access requirements of small and medium-sized enterprises, intelligent village, hotel, office network and campus network.

FR-S3126MC-370P2 24 ports have PoE power supply function, support IEEE802.3at standard, 802.3af downward compatibility, power supply equipment for Ethernet, can automatically detect identification standard of electrical equipment, and through the cable for the power supply.

#### The application of topology

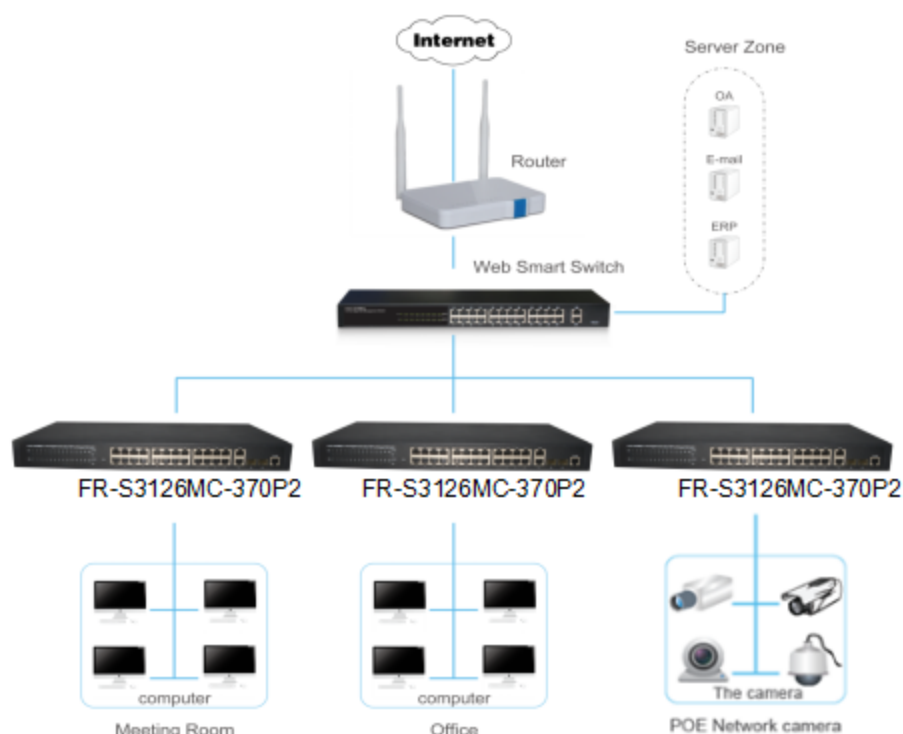

● **24FE+2-port Gigabit Combo Base-T/SFP L2 Managed PoE Switch** **FR-S3126MC-370P2**

## Features

- Supports IEEE 802.3i, IEEE 802.3z, IEEE 802.3u, IEEE 802.3ab, IEEE802.3x, IEEE802.3at, IEEE802.3af, IEEE802.3az.
- Supports PoE power up to 30W for each PoE port, all power up to 370W
- Supports MAC address auto-learning and auto-aging
- Twenty-four 10/100Mbps self-adaption RJ45 port, and two alternative gigabit ports --two 10/100/1000Mbps RJ45 ports and two 1000Mbps SFP optical ports
- UTP port support automatic negotiation, automatically adjust the transmission mode and the transmission rate.
- Store and forward mode operates.
- LED indicators for monitoring power, link/activity.
- Support QoS, port mirroring, link aggregation protocol
- 19 inches full metal iron shell and internal power adapter design, suitable for rack installation.

## Hardware Specification

|                         |  |                           |
|-------------------------|--|---------------------------|
| Model                   | FR-S3126MC-370P2   |                           |
| Chipset                 | RTL8332M+2*RTL8208L+2*RTL8231+1*RTL8214FC+HT85F2280+3*IP808AR  |                           |
| Standards and Protocols | IEEE 802.3i, IEEE 802.3u, IEEE802.3z, IEEE802.3ab, IEEE802.3x, IEEE802.3az, IEEE802.3af, IEEE802.3at   |                           |
| Interface               | 24 x 10/100Mbps ports<br>2x 100/1000Mbps ports or 2X 1000Mbps SFP ports<br>1x RJ45 Console port  |                           |
| Network Media (Cable)   | 10Base-T: UTP category 3, 4, 5 cable (maximum 100m)<br>100Base-Tx: UTP category 5, 5e cable (maximum 100m)<br>1000Base-T: UTP category 5e, 6 cable (maximum 100m)<br>1000Base-SX: 62.5µm/50µm MMF(2m~550m)<br>1000Base-LX: 62.5µm/50µm MMF(2m~550m) Or 10µm SMF (2m~5000m) |                           |
| Transfer Method         | Store-and-Forward  |                           |
| MAC Address Table       | 8K   |                           |
| Switching Capacity      | 8.8Gbps  |                           |
| Packet Forwarding Rate  | 6.54Mpps   |                           |
| Packet Buffer           | 4.1Mbits   |                           |
| Jumbo Frame             | 9KBytes  |                           |
| PoE Ports(RJ45)         | 24x PoE ports compliant with 802.3at/af  |                           |
| Power Pin Assignment    | 1/2(+),3/6(-)  |                           |
| PoE Budget              | 370W   |                           |
| LED indicators          | Per Device   | Power: Green SYS: Green   |
|                         | Per Port   | Link/Act:Green POE:Yellow |
| Power                   | AC 100V~240V 50/60HZ 400W (Internal Power supply)  |                           |
| Power Consumption       | 414W MAX( 220V/50Hz)   |                           |
| Dimensions (W × D × H)  | 440x208x44mm (19" metal case)  |                           |
| Environment             | Operating Temperature: 0°C - 45°C<br>Storage Temperature: -40°C - 70°C<br>Operating Humidity: 10%~90% non-condensing<br>Storage humidity: 5%~95% non-condensing  |                           |

## Software Specification

|                     |  |
|---------------------|--|
| System              | IP Configuration(IPV4、IPV6)                  |
|                     | User Configuration                           |
|                     | Time Settings(SNTP)                          |
|                     | Log Management                               |
|                     | SNMP Management(V2)                          |
|                     | RMON   |
| Port                | Port Configuration                           |
|                     | Link Aggregation(static、Lacp)                |
|                     | Port Mirroring                               |
|                     | Jumbo Frame                                  |
| Vlan                | Port based VLAN                              |
|                     | Protocol based VLAN                          |
| IGMP                | IGMP Snooping (V2、V3)                        |
|                     | Multicast group (256)                        |
| STP                 | IEEE 802.1D STP                              |
|                     | IEEE 802.1W RSTP                             |
|                     | IEEE 802.1S MSTP                             |
| Security            | Broadcast / Uncast / Multicast Storm Control |
|                     | IEEE 802.1x                                  |
|                     | DHCP Snooping (IP、MAC、Port)                  |
| ACL                 | MAC-Based ACL                                |
|                     | MAC-Based ACE                                |
|                     | IPv4-Based ACL                               |
|                     | IPv4-Based ACE                               |
| QoS                 | WRR (Weighted Round Robin)                   |
|                     | Port based QoS                               |
|                     | IEEE 802.1p Class of Service                 |
|                     | DSCP-based QoS                               |
|                     | QoS basic mode                               |
|                     | QoS advanced mode (Policy based)             |
| Bandwidth Control   | Ingress Port                                 |
|                     | Ingress VLAN                                 |
|                     | Egress Port                                  |
|                     | Egress Queue                                 |
| MAC Address Setting | Static Mac Setting                           |
|                     | MAC Filtering                                |
|                     | Dynamic Address Learn/Setting                |
| LLDP                | LLDP Port Setting                            |
| Management          | System Status                                |
|                     | Ping Test                                    |
|                     | Factory Reboot Switch                        |
|                     | Backup/Upgrade Manager                       |
|                     | Configuration Manager                        |